

- 1 ANCHOR
- 2 CHAIN LOCKER
- 3 FOREDECK
- 4 SWL MARK
- 5 GATE
- 6 GUNLARS
- 7 WIREHOUSE
- 8 DOOR
- 9 HATCH
- 10 HANDRAIL
- 11 BILGE PUMP & LIFEBOUY
- 12 NAVIGATION SIDE LIGHT
- 13 NAVIGATION MAST LIGHT
- 14 FASHION PLATE
- 15 NAME BOARDS
- 16 LIFEBOUY
- 17 SUBSTANT APPARATUS
- 18 ENTRANCE DOORS
- 19 FIXED WINDOW (HATCHES)
- 20 OPENING WINDOW
- 21 TANK SPACE
- 22 MECHANICAL SPACE
- 23 ACCESS HATCH
- 24 STAIRS
- 25 WATERLINE
- 26 RECEPTION AREA
- 27 UPPER DECK (BAR)
- 28 DINING ROOM
- 29 TOILETS
- 30 WOOD CUTTING
- 31 KITCHEN
- 32 BEER STORE
- 33 DOOR
- 34 HATCH
- 35 STAIRWAY
- 36 NAVIGATION STEER LIGHT
- 37 ROPEWALKER & ROLLER
- 38 FLOOR
- 39 ROCKER QUARTER
- 40 IMPACT POSITION

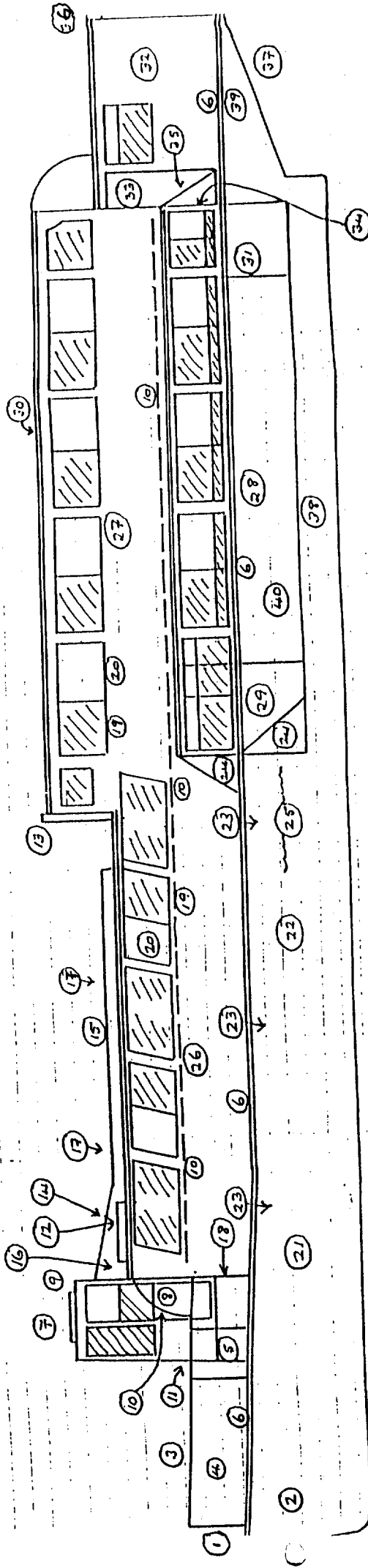

MARCHIONESS

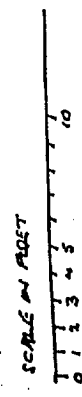

FOREDECK HAS BEEN REDUCED  
BY ABOUT FIVE FEET IN THIS  
PROFILE TO SUIT MARCH SIZE.  
EX 1957 (SEPTEMBER 1959)

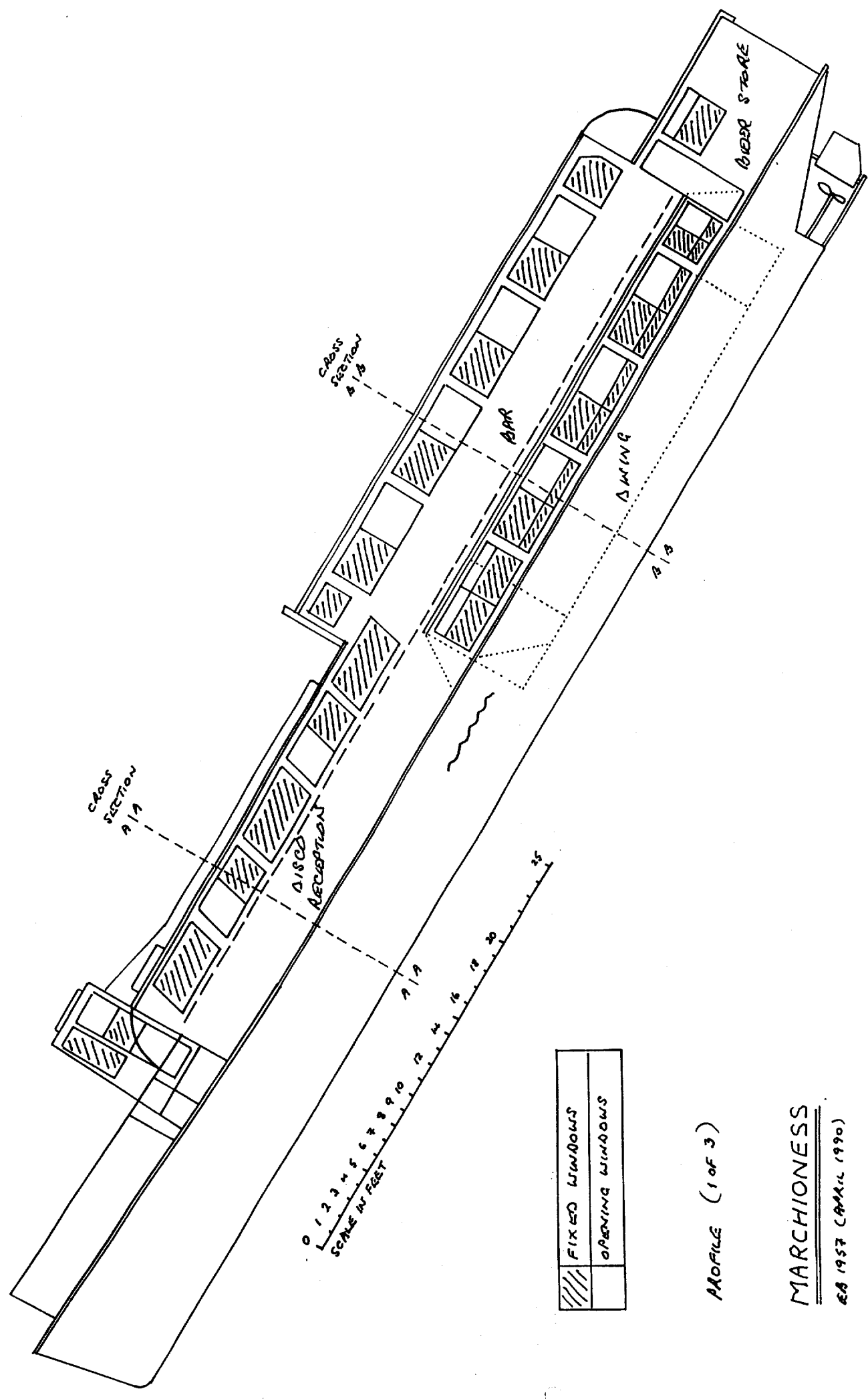

CROSS SECTION A/A

CROSS SECTION B/B

DISCO RECEPTION

BAR

AWNING

BOARD STORE

0 1 2 3 4 5 6 7 8 9 10 11 12 13 14 15 16 17 18 19 20 21 22 23 24 25

SCALE IN FEET

/ / /	FIXED WINDOWS
	OPENING WINDOWS

PROFILE (1 OF 3)

MARCHIONESS

EA 1957 (APRIL 1990)

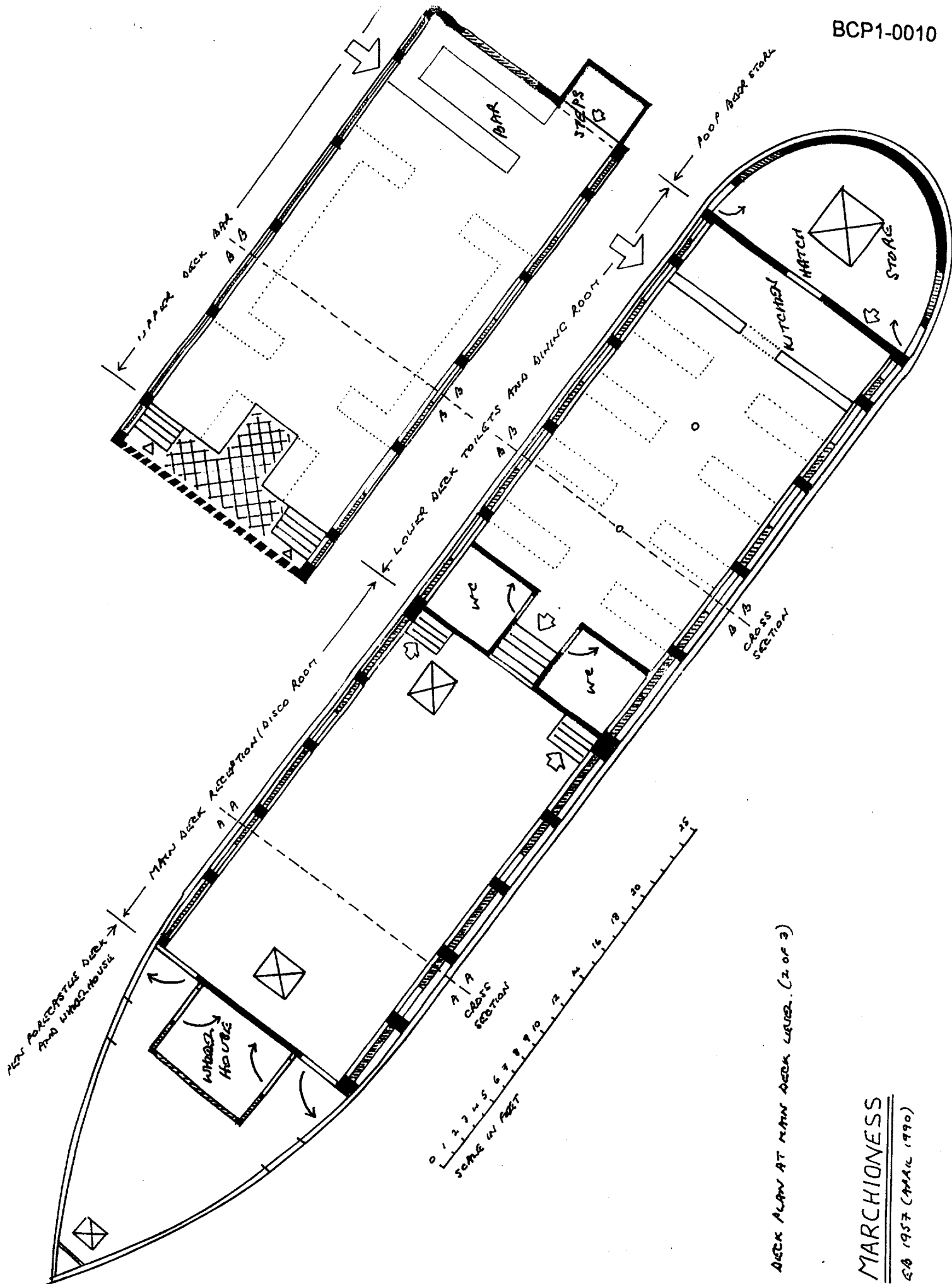

DECK PLAN AT MAIN DECK LEVEL. (2 OF 3)

MARCHIONESS  
EA 1957 (MAY 1990)

SECTION AT ABOUT 2/3 LENGTH THROUGH UPPER DECK AREA AND LOWER DECK DINING ROOM - LOOKING FORWARD TOWARDS TOILETS AND STAIRWAY UP TO MAIN DECK LEVEL.

CROSS SECTION BB

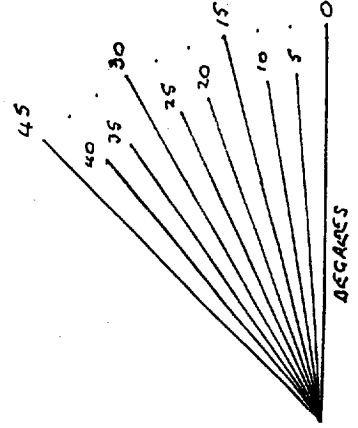
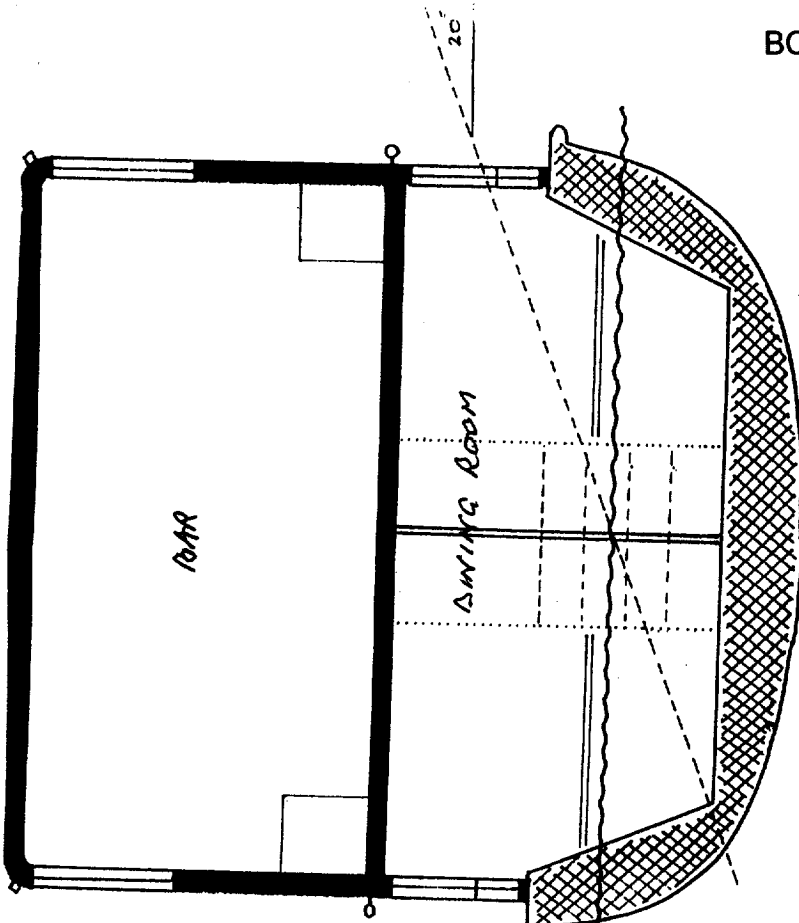

SECTION AT ABOUT 1/3 LENGTH THROUGH MAIN DECK RECEPTION DISCO AREA - LOOKING FORWARD TOWARDS WAREHOUSE AND TWO DOORS OPPOSITE TO MAIN DECK.

CROSS SECTION AA

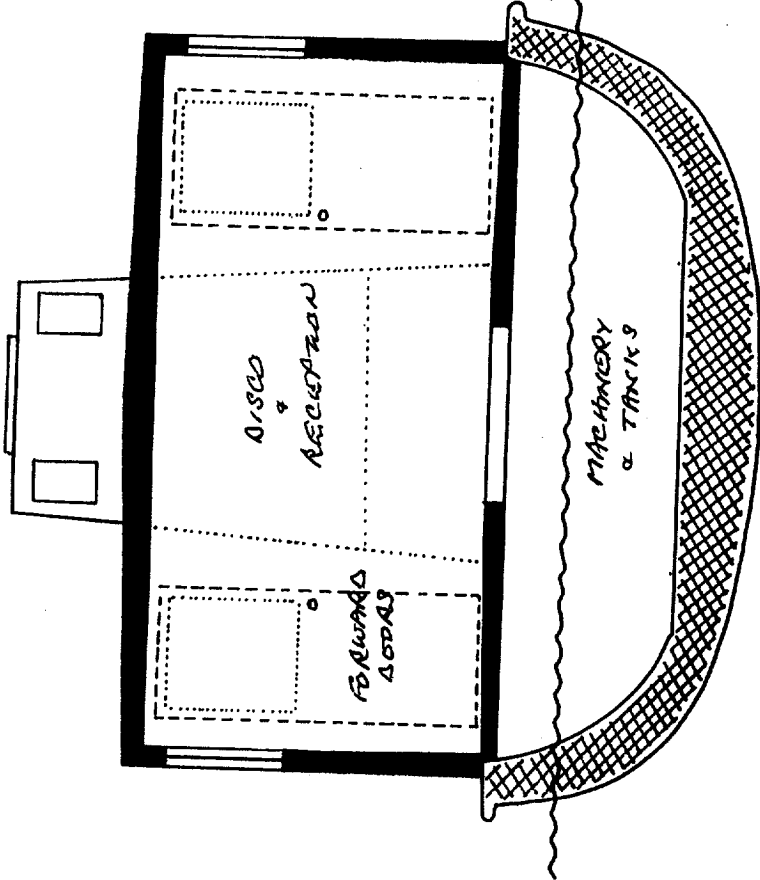

FACEBOARD + DRUGHT = 58 ARCHES

CROSS SECTIONS (3 OF 3)

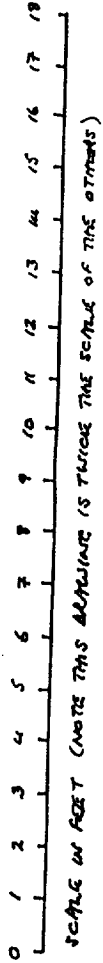

MARCHIONESS

EA 1957 (APRIL 1990)